

Electrical Characteristics :
 Insulation Resistance : 500MQ Min.
 Contact Resistance : 50mΩ Max.
 Withstand Voltage : 1000 VAC 1 minute.
 Current Rating : 1.5A

Material:
 Housing: Thermoplastic UL 94V-0
 Contact : Selective Gold Plating
 Terminal: 0.35mm Thickness Phosphor Bronze
 Plated With Gold And Tin In Solder Area.
 Shielded: Brass ,Nickel Plating
 CUL File No : E215573

PART NO : 8 3 8 6 C - B * 1 * S

Positions **Ports** **Contacts**

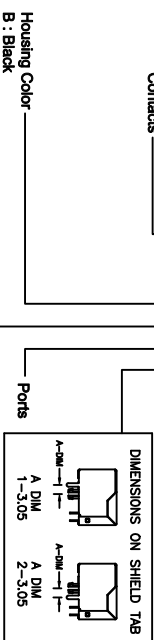

- Housing Color**
 B : Black
- Gold Plated**
 0 : Gold Plated
 1 : 6u"
 2 : 15u"
 3 : 30u"
 4 : 50u"

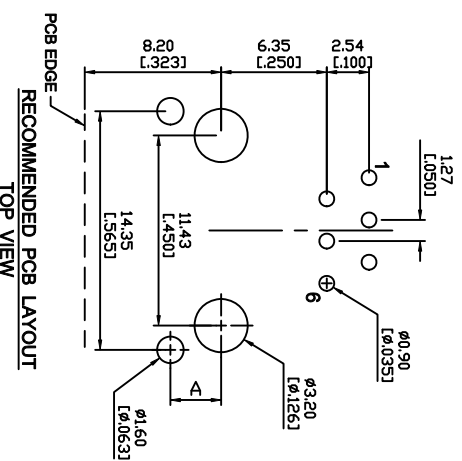
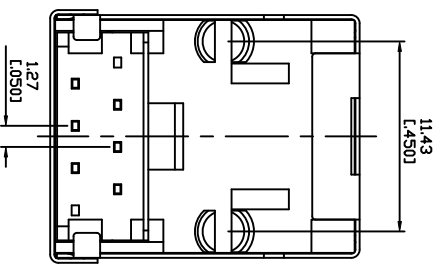
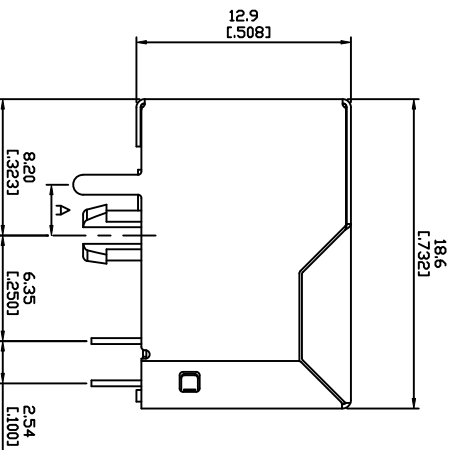
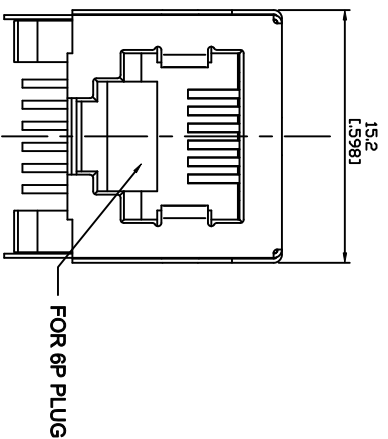

ZONE	REV.	DESCRIPTION	DATE	APPD.
Ⓐ				
Ⓑ				
Ⓒ				
Ⓓ				
Ⓔ				

FILE NO : 83 (SERIES)

TOLERANCE (公差) :
 0.000 mm ± 0.075mm
 0.00 mm ± 0.15mm
 0.0 mm ± 0.25mm

 博 威 電 子 股 份 有 限 公 司 POWERWAY ELECTRONICS CO.,LTD.		TITLE	RJ11,Shielded,Receptacle	UNIT	mm
		圖名	Horizontal, 1 Port, THT (for 6P Plug)	單位	inch
PART NO.	料號	8386C-B*1*S	SCALE	比例	1:1
REV.	版本	A.0	DATE	日期	2009-09-25
CHECKED BY	審核	Aaron	DRAWN BY	製圖	Eric